

# DAEMO

DAEMO ENGINEERING CO., LTD.

## DAEMO ENGINEERING CO., LTD (HEAD QUARTER)

15, GUNJACHEON-RO, SIHEUNG-SI, GYEONGGI-DO, KOREA  
TEL : +82-31-488-6000 (Rep.) FAX : +82-31-496-0066  
Home page : <http://www.daemo.co.kr>  
E-mail : [chpark@daemo.co.kr](mailto:chpark@daemo.co.kr)

## DAEMO EUROPE N.V.

MOESTOEMAATHEIDE 15, B-2440 GEEL, BELGIUM  
TEL : +32 (0) 14-59-2363 FAX : +32 (0) 14-59-0316  
Mobile : +32-472-220-496  
E-mail : [smilk@daemo.co.kr](mailto:smilk@daemo.co.kr) (Mr. Bread Joon)  
[alex@daemo.co.kr](mailto:alex@daemo.co.kr) (Mr. Alex Kim)

## DAEMO ENGINEERING INDIA PRIVATE LIMITED

OFFICE NO 15, GULISTAN BUILDING , POONA COLLEGE  
ROAD, PUNE 411001  
TEL : +91-20-2643-6162 Mobile : +91-9145082540  
E-mail : [jasonpark@daemo.co.kr](mailto:jasonpark@daemo.co.kr) (Mr. Jason Park)

## DAEMO AMERICA INC.

6675 DOOLITTLE AVE BLDG A, RIVERSIDE, CA 92503, US  
TEL : +1-951-688-8300 FAX : +1-951-688-8500  
Mobile : +1-951-756-9555  
E-mail : [samkim@daemo.co.kr](mailto:samkim@daemo.co.kr) (Mr.Samuel Kim)  
[william@daemo.co.kr](mailto:william@daemo.co.kr) (Mr.Wiliam Kim)

## CHANGZHOU DAEMO MACHINERY CO., LTD

NO 269, HUANGHEXI RD, XUEJIA INDUSTRIAL COMPLEX,  
CHANGZHOU CITY, JIANGSU PROVINCE, CHINA  
TEL : +86-0519-8595-9000 FAX : +86-0519-8595-9009  
Mobile : +86-1865-198-0033  
E-mail : [nshee666@daemo.co.kr](mailto:nshee666@daemo.co.kr) (Mr.SH Nam)

# Attachments Full Line-Up

Best In Class Durability, Reliability  
& Performance



# DAEMO

DAEMO ENGINEERING CO., LTD.

## Constant Innovation is our Passion

For over two decades, we have constantly developed future oriented hydraulic attachments to meet changing attachment market requirements.

Always with our passion in mind, we work with customers, end-users and suppliers to produce innovative solutions and to achieve customer satisfaction as quickly and efficiently as possible.

Our continuous efforts on R&D, vast field experience and producing know-how characterize our quality products and secure our position as one of the leading hydraulic attachment manufacturers in Korea.

This is how we constantly innovate ourselves and keep our passion alive.



Constant Passion



Quality Management System



Customer Satisfaction

- 2016** Established a branch office in India
- 2014** Chosen as “World Class 300 Company” by Small Medium Business Administration
- 2013** Awarded Presidential Prize for Excellent Contribution on Korean Construction Machinery Industry.
- 2011** Awarded the prize of USD 30 million export.
- 2010** Acquisition of “Strong Exporter Certificate” from Industrial Bank of Korea
- 2007** Acquisition of “ISO14001” & Awarded the prize of USD 20 million export.

- 2003** Established a branch office in China and Europe
- 2000** Established a branch office in California, USA.
- 1998** Awarded Presidential Prize for Excellent Machinery
- 1995** Acquired “CE” Certification from TUV in Germany
- 1992** OEM Agreement with Hyundai Heavy Industries & Development Non-Acumulator Type Breaker
- 1989** Founding of Daemo Engineering Co., Ltd.

## CONTENTS

<b>BREAKER</b>	04
alicon breaker	
<b>SHEAR</b>	08
<b>CRUSHER &amp; PULVERIZER</b>	10
Mini Crusher	
Fixed Crusher	
Rotating Crusher	
Rotating Pulverizer	
<b>MULTI PROCESSOR</b>	14
Multi Processor (Quick Change)	
<b>CAR DISMANTLER</b>	16
<b>GRAPPLE</b>	17
Orange Grapple	
Wood Grapple (Link)	

<b>RAKE</b>	19
<b>MAGNET</b>	20
<b>RIPPER</b>	21
<b>COMPACTOR</b>	22
<b>QUICK COUPLER</b>	23
Triple Safety Quick Coupler	
<b>MATERIAL HANDLER</b>	25
<b>CLAMSHELL BUCKET</b>	26

# alicon Breaker



Top Box Type  
(Low noise)

Top Box Type  
(Standard)

Top Split Type

Side Type

Skid Loader Type

Backhoe Type

## FEATURES

- New alicon series breaker became Lighter, Stronger and more Powerful than ever.
- Enlarged the diameter of T/Bolt improved its durability.
- Changed the hose connecting port from Split Flange structure In/Out port to New Adaptor type port (Prevent bolt breakage and oil leakage : B06~B1000).
- Switched Box Housing to Bending design for more durability.
- Diversified 20 products lines to fit to any work conditions.
- Redesigned chisel pin has improved durability.
- Enlarged chisel's diameter improved more powerful impact.
- Anti Blank Firing system increased the life of breaker (Chisel Pins, T/Bolts, F/Head, etc).
- More options: Anti Blank Firing On/Off valve, TPC system (2 stages stroke valve), Internal Relief Valve, BPM adjust Valve, Provision Hole for underwater works and Auto Grease System.

## SPECIFICATIONS

Description	Unit	B06	B10	B20	B30	B40	B60	B50	B70	B90	B140	B180	B210	B230	B250	B300	B360	B450	B650	B800	B1000	
Suitable Excavator	ton	0.5~1.2	1~1.5	1~2.5	2~4	3~4.5	5~7	3~6	6~8	7~12	10~15	16~20	18~25	18~25	22~29	26~32	28~36	40~50	42~81	55~100	85~140	
Control Valve Type		Internal built-in Control valve						Outer Control valve installed without Accumulator						Outer Control valve installed with Accumulator						Internal c.valve		
Operating Weight	Side	kg	*	80	100	130	162	291	271	340	513	773	1,199	1,647	1,663	2,020	2,796	2,806	3,628	*	*	*
	Top Box	kg	68	115	150	180	224	375	333	431	614	929	1,209	1,738	1,777	2,165	2,832	2,937	3,713	4,380	5,625	8,060
Overall Length	Side	mm	*	964	1,080	1,145	1,192	1,620	1,560	1,657	1,842	1,903	2,094	2,348	2,348	2,457	2,732	2,732	3,070	*	*	*
	Top Box	mm	932	1,110	1,239	1,334	1,408	1,635	1,603	1,805	1,981	2,225	2,455	2,764	2,764	2,898	3,200	3,200	3,595	3,766	4,059	4,875
Chisel Out Diameter	mm	40	40	45	53	62	75	70	78	85	105	120	135	140	145	150	155	165	180	200	220	
Chisel Length	mm	358	420	500	570	610	780	730	806	850	975	1,165	1,250	1,250	1,280	1,400	1,400	1,650	1,500	1,700	1,900	
Setting Pressure	kgf/cm <sup>2</sup>	150	150	150	150	150	180	170	180	190	190	210	210	210	210	210	210	210	240	240	240	
Working Pressure	kgf/cm <sup>2</sup>	70~120	70~110	80~120	80~120	100~140	100~140	100~140	100~140	100~140	120~160	120~170	130~170	130~180	140~180	140~180	140~180	140~180	150~190	150~190	175~200	
Oil Flow	LPM	10~22	15~30	20~40	25~45	30~50	35~70	30~55	45~80	50~100	90~110	100~140	110~160	130~170	150~210	180~250	180~250	200~280	280~400	320~450	380~455	
Blow Rate(High Speed)	BPM	600~1,200	600~1,200	600~1,200	600~1,100	500~1,000	350~800 (450~1,100)	350~900 (450~1,000)	350~900 (450~1,000)	300~700 (550~950)	350~550 (500~750)	350~550 (500~850)	350~500 (450~600)	250~400 (350~500)	250~350 (300~450)	200~350 (300~480)	200~350 (300~480)	200~300 (300~450)	250~420 (300~500)	200~350 (250~400)	300~360	
Back Head N <sub>2</sub> Gas Pressure	kgf/cm <sup>2</sup>	12	12	12	12	12	12	12	12	12	12	12	11	11	11	11	11	11	16	11	11	



# Scrap Shear (Long Body Type)



### FEATURES

- Maximized cutting force.
- H-beam and I-beam can be cut in a single cut.
- Easier cutter replacement.
- Speed-up valve accelerates work speed (Standard)
- Hardox 400 for heavy duty body



### SPECIFICATIONS

Description	Unit	Guide Block Type			
		DMS350	DMS400	DMS550X	DMS700
Operating Weight	kg	3,550	5,300	6,800	7,900
	lb	7,826	11,684	14,991	17,416
Max. Opening Width	mm	672	710	802	896
	inch	26.5	28	31.8	35.3
Overall Length	mm	3,508	4,625	5,050	5,480
	inch	138.1	182	198.8	215.7
Cutting Force(Max)	ton	660	1,150	1,500	1,750
Max. Cutting Speed (Open / Close)	Sec	4.6 / 4.2	5.5 / 5.3	9.7 / 5.8	8.2 / 4.9
Operating Pressure	kgf/cm <sup>2</sup>	350	350	350	350
	psi	4,978	4,978	4,978	4,978
Oil Flow Rate	LPM	180~	200~	250~	320~
	GPM	47.6~	52.8~	66.1~	84.6~
Excavator Class	ton	18-(2nd) 30-(3rd)	25-(2nd) 41-(3rd)	36-(2nd) 50-(3rd)	42-(2nd) 73-(3rd)

Description	Unit	Guide Block Type				
		DMS350	DMS400	DMS550X	DMS700	
Cutting Capability	mm	H-Beam	300X300	350x350	380x380	450x450
		I-Beam	350X150	400x175	600x190	600x190
		Solid Round	60	70	80	90
		Channel Plate	425X100X10	425x100x10	425x100x10	425x100x10
		Angle Plate	200X200X20	200x200x25	250x250x25	250x250x30

# Shear (Short Body Type)



### FEATURES

- 360° workable direction.
- H-beam and I-beam can be cut in a single cut.
- Easier cutter replacement.
- Speed-up valve accelerates work speed (Optional)
- Light weight and High durability

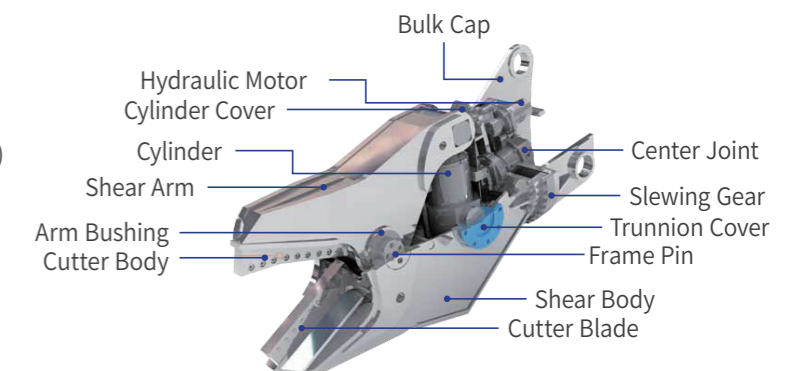

### SPECIFICATIONS

Description	Unit	None Guide Block Type		Demolition	Guide Block
		DMS250	DMS300	DMS330	DMS360
Operating Weight	kg	2,200	2,920	2,790	3,450
	lb	4,850	6,437	6,151	7,606
Max. Opening Width	mm	668	570	806	456
	inch	26.3	22.4	31.7	18.0
Overall Length	mm	2,353	2,410	2,588	2,690
	inch	92.6	94.9	101.9	105.9
Cutting Force(Max)	ton	259	370	347	495
Operating Pressure	kgf/cm <sup>2</sup>	320	320	320	320
	psi	4,552	4,552	4,552	4,552
Oil Flow Rate	LPM	200-250	250-300	250-300	290-320
	GPM	52.8-66.1	66.1-79.3	66.1-79.3	76.7-84.6
Excavator Class	ton	22-27	27-33	27-33	33-45

Description	Unit	None Guide Block Type		Demolition	Guide Block	
		DMS250	DMS300	DMS330	DMS360	
Cutting Capability	mm	H-Beam	150x150	200x200	200x200	300x300
		I-Beam	200x125	300x150	300x150	350x150
		Solid Round	40	50	50	60
		Channel Plate	250x90x13	380x100x16	380x100x16	425x100x10
		Angle Plate	100x100x10	150x150x15	150x150x15	200x200x20

# Mini Crusher



## FEATURES

- Dual Cylinder system for speedy & powerful operation.
- Improved durability using Hardox material.
- Easy maintenance.
- High performance & Low vibration.
- Speed-up valve accelerates work speed (optional).
- Free rotating type (standard).



# Fixed Crusher



## FEATURES

- Durability with wear-resistant tooth material.
- Low noise, less vibration design.
- Dual purpose : crushing concrete and cutting steel bars.
- Tooth replacement and speed-up valve (optional).
- Welding tooth type and Bolting tooth type available.



## SPECIFICATIONS

Description	Unit	DMC10	DMC11	DMC30	DMC31	DMC50	DMC51
Operating Weight	kg	160	170	265	310	420	420
Max. Opening Width	mm	330	360	410	430	520	530
Crushing Force (End)	ton	17	22	25	28	35.2	32
Excavator Class	ton	1.5~3		2.5~5		4~8	
Cylinder Type	ea	2	1	2	1	2	1

## SPECIFICATIONS

Description	Unit	DMC140	DMC140B	DMC180	DMC180B	DMC210	DMC210B	DMC300	DMC300B
Operating Weight	kg	1,314	1,350	1,418	1,450	1,926	1,980	2,550	2,600
	lb	2,897	2,976	3,216	3,197	4,246	4,365	5,622	5,732
Max. Opening Width	mm	612		728		784		915	
	inch	24.1		28.7		30.9		36.0	
Overall Length	mm	1,965	1,945	2,050	2,020	2,222		2,351	2,380
	inch	77.4	76.6	80.7	79.5	87.5		92.6	93.7
Crushing Force (End)	ton	42		44		57		73	
Operating Pressure	kgf/cm <sup>2</sup>	280		280		320		320	
	psi	3,983		3,983		4,552		4,552	
Oil Flow Rate	LPM	170~220		180~230		200~250		250~300	
	GPM	44.9~58.2		47.6~60.8		52.8~66.1		66.1~79.3	
Excavator Class	ton	13~20		16~22		20~30		27~40	

# Rotating Crusher

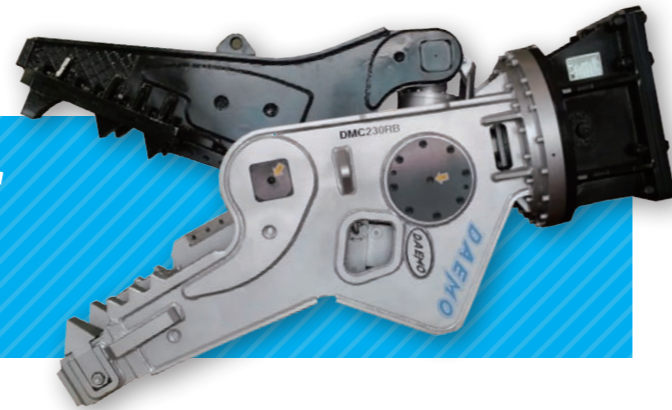

## FEATURES

- 360° workable direction.
- Workable on narrow building spaces or noise regulated environments.
- Speed-up valve accelerates work speed (optional).
- Moving arm tooth replaceable as standard
- Welding tooth type and Bolting tooth type available.



Bolting Type Tooth : Wearable part can be easily replaced.

## SPECIFICATIONS

Description	Unit	DMC230R	DMC230RB	DMC330R	DMC330RB
Operating Weight	kg	2,250	2,300	3,050	3,100
	lb	4,960	5,071	6,724	6,834
Max. Opening Width	mm	780		890	
	inch	30.7		35.0	
Overall Length	mm	2,500	2,480	2,660	2,685
	inch	98.4	97.6	104.7	105.7
Crushing Force (End)	ton	57		73	
Operating Pressure	kgf/cm <sup>2</sup>	320		320	
	psi	4,552		4,552	
Oil Flow Rate	LPM	200-250		250-300	
	GPM	52.8-66.1		66.1-79.3	
Excavator Class	ton	20-30		29-43	

# Rotating Pulverizer



## FEATURES

- Enlarged cutter length & Optimized crushing power
- Cover plate for protecting cylinder
- Speed-up valve accelerates work speed.
- Exchangeable wear parts: arm, body tooth, cutter
- Hardox 400 for high durability

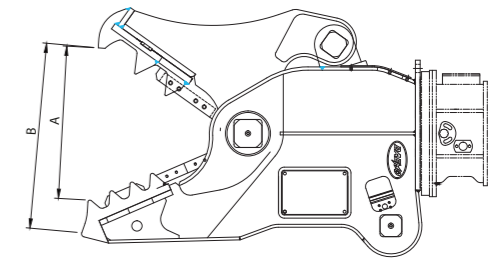

## SPECIFICATIONS

Description	Unit	DRP145	DRP185	DRP235
Operating Weight (Excluding M.BKT)	kg	1,350	1,700	2,200
	lb	2,976	3,748	4,850
Max. Opening Width (A)	mm	640	740	800
	inch	25.2	29.1	31.5
Max. Opening Width (B)	mm	790	900	960
	inch	31.1	35.4	37.8
Overall Length	mm	1,845	1,966	2,177
	inch	72.6	77.4	85.7
Crushing Force (End)	ton	55	85	110
Operating Pressure	kgf/cm <sup>2</sup>	320		
	psi	4,551		
Oil Flow Rate	LPM	170-220	180-220	220-320
	GPM	44.9-58.2	47.6-58.1	58.1-84.5
Open / Close time	Sec	1.8 / 1.4	1.8 / 1.7	1.6 / 1.8
Excavator Class	ton	13-20	18-28	24-32

# Multi Processor



## FEATURES

- Hydraulic rotating motor provides improved mobility.
- Crushing concrete and cutting steel as switching arms.
- 360° full rotating
- Speed-up valve applied (optional)



## SPECIFICATIONS

Description	Unit	DMP130CFS	DMP230CMS	DMP230SM	DMP330CMS	DMP330CML	DMP330SM
Operating Weight	kg	1,200	1,730	1,810	2,850	2,910	3,000
	lb	2,646	3,814	3,990	6,283	6,415	6,614
Max. Opening Width	mm	700	900	486	1,110	1,220	613
	inch	27.6	35.4	19.1	43.7	48	24.1
Overall Length	mm	1,773	2,044	2,247	2,474	2,546	2,508
	inch	69.8	80.5	88.5	97.4	100.2	98.7
Average Crushing Force	ton	60	82	118	136	121	197
Max. Cutting Force	ton	251	577	343	584	584	559
Operating Pressure	kg/cm <sup>2</sup>	280	320	320	320	320	320
	psi	3,983	4,552	4,552	4,552	4,552	4,552
Oil Flow Rate	LPM	170-220	200-250	200-250	250-300	250-300	250-300
	GPM	44.9-58.2	52.8-66.1	52.8-66.1	66.1-79.3	66.1-79.3	66.1-79.3
Excavator Class	ton	13-20	18-30	18-30	29-43	29-43	29-43

# Multi Processor (Quick Change)

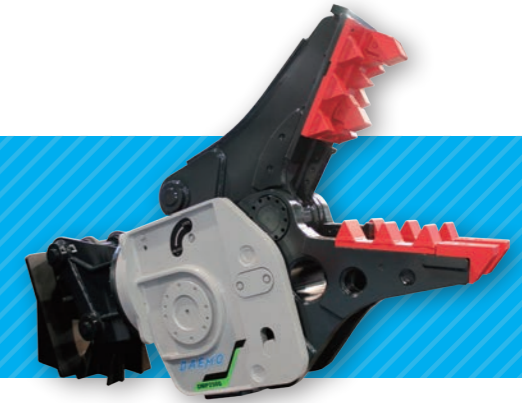

## FEATURES

- Replaceable arms and tooth (Crusher, Shear, Demolition and Pulverizer)
- Best material 'Hardox Hituf' and 'Hardox 400'
- Required Arm can be replaced within 10 minutes (Quick Change)
- Speed-up valve increases work efficiency (Standard)

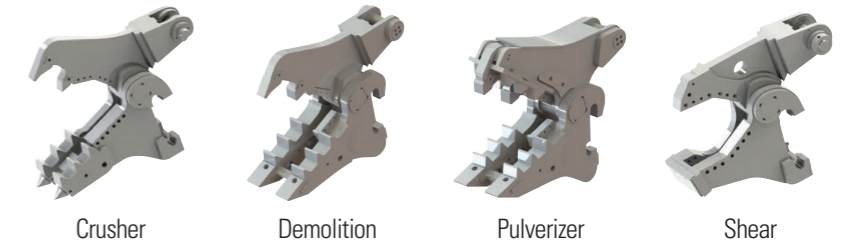

## SPECIFICATIONS

Description	Unit	DMP200Q				DMP300Q			
		Crusher	Demolition	Pulverizer	Shear	Crusher	Demolition	Pulverizer	Shear
Operating Weight	kg	2,183	2,190	2,200	2,037	2,900	2,820	2,826	2,698
Crushing Force (Tip)	ton	59	60	60	85	85	85	85	120
Crushing Force (Mid)	ton	82	98	92	140	120	140	130	190
Opening Width	mm	791	727	843	393	875	940	945	480
Width Upper Jaw	mm	127	127	310	99	80	80	316	120
Width Lower Jaw	mm	360	360	380	250+200	426	500	490	352
Cutter Length	mm	180x2	200	200	200	200+200	200	200	300+250
Operating Pressure	kg/cm <sup>2</sup>	320				320			
Oil Flow Rate	LPM	120-200				200-250			
Cycle Time (Open/Close)	sec	2.0/2.1				2.0/2.3			
Rotation Pressure	kg/cm <sup>2</sup>	160				160			
Rotation Flow	LPM	36-40				36-40			
Excavator Class	ton	18-30				28-43			



## Car Dismantler



### FEATURES

- Clamp arm and 360° rotating cutter enables elaborate work.
- Speedy demolition without pre-process.
- Car dismantle work can be performed by one machine.
- Engine pulling type available.



### SPECIFICATIONS

Description	Unit	DMCP140R	DMCP140R(Engine Puller)	DMCP230R	DMCP300R
Rotation Type		Rotating Head type			
Operating Weight	kg	870	990	1,800	2,880
Max. Opening Width	mm	700	807	600	866
Max. Cutting Force	ton	49	-	170	303
Cutter Length	mm	225	-	225	225X2
Operating Pressure	kg/cm <sup>2</sup>	320	320	320	320
Oil Flow Rate	LPM	170-220	170-220	200-300	250-300
Excavator Class	ton	13-18	13-18	20-28	27-33

## Orange Grapple

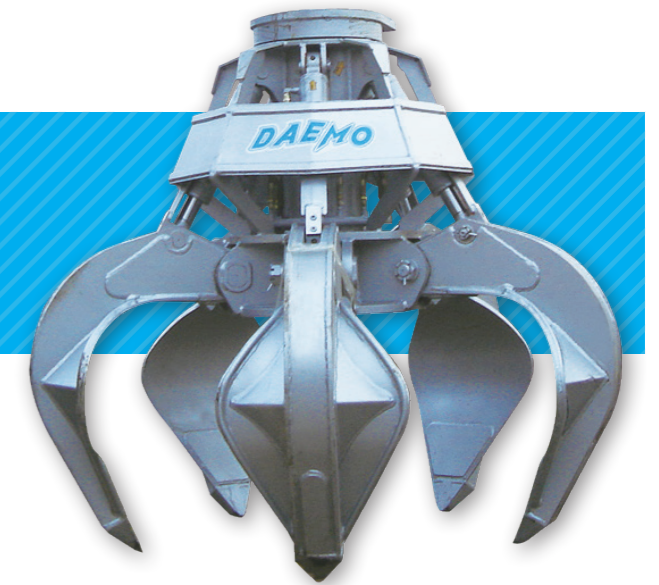

### FEATURES

- Loading / Unloading metal scrap, waste and garbage.
- Pendulum type.
- Tine type : Half-sealed (Standard)
- Rotating type : Hydraulic

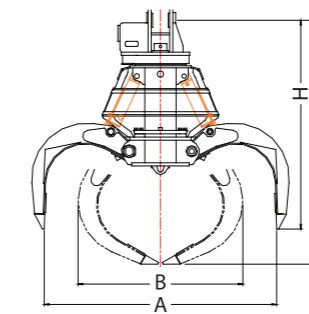

### SPECIFICATIONS

Description	Unit	DMSG800
Operating Weight	kg	1,200
Capacity	m <sup>3</sup>	0.7
Max Clamping Force	ton	10.8
(A) Max Opening Width	mm	1,820
(B) Closing Width	mm	1,290
(H) Opening Length	mm	1,630
(H1) Overall Length	mm	1,905
Excavator Class	ton	18-25
Standard Tines No.	ea	5

# Wood Grapple



## FEATURES

- Link Type mounting bracket.
- Rotating Type.
- Loading/unloading timbers, logs and pipes.
- Wide jaws suitable for various work requirement
- High efficiency.

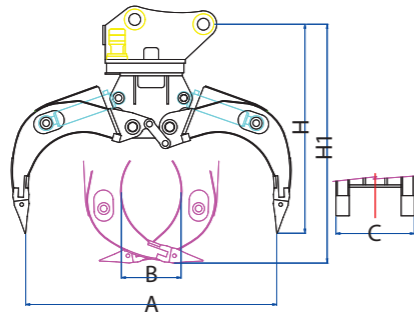

# Sorting Grab / Rake



## FEATURES

- Link type mounting bracket.
- Rotation option : fixed or hydraulic
- Tooth replacement type.
- Powerful performance with two cylinders.

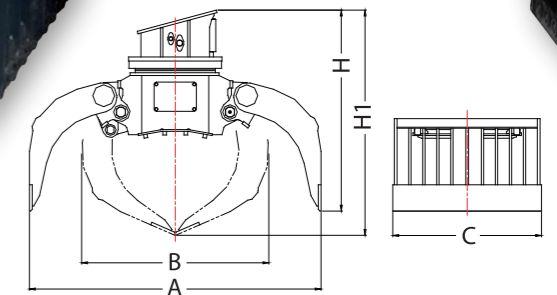

## SPECIFICATIONS

Description	Unit	Link Type
		DMWL800
Operating Weight	kg	890
Capacity	m <sup>2</sup>	0.55
Max Clamping Force	ton	17.7
(A) Max Opening Width	mm	1,700
(B) Closing Width	mm	304
(C) Jaw Width	mm	670
(H) Height (Open)	mm	1,545
(H1) Overall Length	mm	1755
Excavator Class	ton	18-25

## SPECIFICATIONS

Description	Unit	DMR160	DMR300	DMR600	DMR800	DMR1000
Operating Weight	kg	370	550	970	1,300	2,200
Capacity	m <sup>3</sup>	0.16	0.23	0.36	0.6	0.93
Max Clamping Force	ton	2.4	2.8	3.7	5	7.4
(A) Max Opening Width	mm	1490	1,600	1,790	2,180	2,445
(B) Closing Width	mm	810	987	1,210	1,356	1,485
(C) Jaw Width	mm	600	630	800	1,000	1,100
(H) Height (Open)	mm	857	1,076	1,216	1,437	1,595
(H1) Overall Length	mm	1,006	1,247	1,379	1,682	1,900
Excavator Class	ton	5-9	7-12	14-20	18-30	26-43

# Magnet



## FEATURES

- Extended operational area.
- High efficiency for loading / unloading metal scrap.
- Reduced cost of follow-up maintenance.
- Type options : fixed, link, knuckle and grapple.
- Convenient maintenance using hydraulic generator

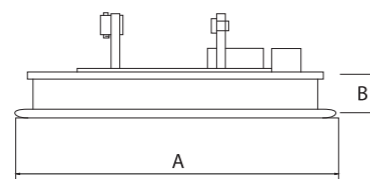

## SPECIFICATIONS

Description	Unit	DMSL920	DMSL1150	DMSL1350	DMSL1550	DMSL1850	
Operating Weight	kg	850	1,400	1,850	2,300	3,000	
Measurement	A	ø	920	1,150	1,350	1,550	1,850
Capacity	Iron plate		9,000	14,000	19,000	24,000	27,000
	lump of iron	kg	200	600	1,200	1,600	2,000
	Scrap		200	400	800	1,000	1,200
Electric Current	A	26	43	60	78	95	
Hydraulic Generator (Max)	kW	10	15(STD) / 20(OPTION)	20	30		
Magnetic Coil Power(Max)	kW	9	14.5/19.5	19.5	29.5		
Excavator Class	ton	10~55	18~25	25~32	32~45	47~50	

# Ripper



## FEATURES

- Scarify frost and hard ground prior to using a bucket
- Used for removing stumps, roots or rebar.
- High strength and solid body.
- Single & Double points type available.

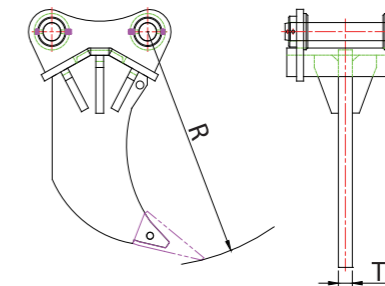

## SPECIFICATIONS

Description	Unit	DMSR140	DMDR140	DMSR230	DMDR230	DMSR360	DMDR360	DMSR450	DMDR450
Point Option		Single	Double	Single	Double	Single	Double	Single	Double
Operating Weight	kg	230	310	390	580	770	1,100	770	1,100
Shank Thickness (T)	mm	450		750		80		80	
Tip Radius (R)	mm	940		1,050		1,290		1,290	
Excavator Class	ton	11~14		16~25		25~32		36~50	

# Compactor



## FEATURES

- High compaction efficiency for ground, trench and slope.
- Requires breaker piping line (S/ACT) (additional)
- Control block system for easy & safe setting.
- Robust design with bending structure & hub type damper.

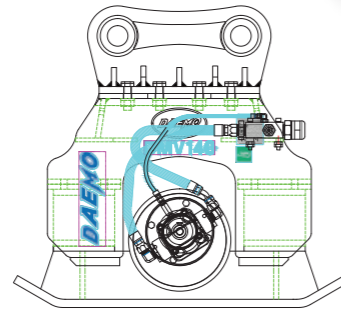

## SPECIFICATIONS

Description	Unit	DMV50	DMV140	DMV230	DMV300	
Max. Impulse Force	ton	2.3	3.7	7.5	11	
Operating Weight	kg	342	624	850	1,282	
Compact Area	Width	mm	450	650	750	900
	Length	mm	700	750	1,000	1,200
Flow Rate Range	LPM	30~55	90~110	130~170	180~250	
Max. Cycle Per Minute	RPM	2,500	2,500	2,200	2,200	
Operating Pressure	Kgf/cm <sup>2</sup>	100~140	120~160	130~180	140~180	
Excavator Class	ton	2~7	8~15	15~22	25~47	

# Quick Coupler



## FEATURES

- Various applications with the wide Pin-to-Pin distance.damper.
- Outstanding durability by using abrasion-resistant and high strength material.
- Safety valve integrated cylinder and manual safety pin.

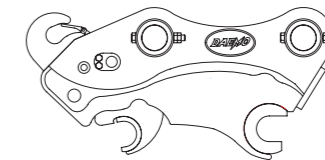

Open Hook Type

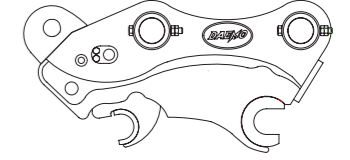

Close Hook Type

## SPECIFICATIONS

Description	Unit	DMQ16	DMQ27	DMQ35	DMQ50	DMQ70	DMQ80	DMQ140
Operating Weight	kg	31	38	40	72	85	92	184
Setting Pressure	Kgf/cm <sup>2</sup>	40~210	40~210	40~210	40~210	N/A	40~280	40~320
Oil Flow	LPM	10~20	10~20	10~20	10~20	N/A	10~20	10~20
Bucket Pin	mm	ø30	ø35	ø40	ø45	ø45	ø55	ø65
Pin-to-pin distance	mm	140~161.5	175~210	195~227	285~293	342	285~341	380~445
Excavator Class	ton	1.6	2.7	3.5	5	7	8	14

Description	Unit	DMQ170	DMQ230	DMQ290	DMQ360	DMQ450	DMQ500	DMQ800
Operating Weight	kg	352	374	556	680	692	719	1,126
Setting Pressure	Kgf/cm <sup>2</sup>	40~320	40~320	40~350	40~350	40~350	40~350	40~350
Oil Flow	LPM	10~20	10~20	10~20	10~20	10~20	10~20	10~20
Bucket Pin	mm	ø70	ø80	ø90	ø100	ø100	ø120	ø130
Pin-to-pin distance	mm	399~440	444~500	510~530	540~560	560~600	560~600	720~725
Excavator Class	ton	17	21	25~30	32~36	45~48	50~52	80

# Quick Coupler (Triple Safety)



### FEATURES

- Improved durability using Hardox 400 (Hitch & Hook)
- Robust structure with Triple Safety locking system
- Automatic locking mechanism for both front and rear without leaving the cabin
- Rear Pin Lock allows the operator to clearly see from the cabin.



Compressed Spring with Cylinder Cover



Easy Switching Attachments



Safe Operation with Red Safety Bar

### SPECIFICATIONS

Description	Unit	DMQ16TS	DMQ27TS	DMQ35TS	DMQ50TS		DMQ80TS	DMQ140TS
Manufacturing Type		Cast Steel			Cast Steel	Welding	Welding	
Operating Mode		Sliding(Push) + Triple Safety						
Operating Weight	kg	31	44	47	74	70	94	170
Setting Pressure	Kgf/cm <sup>2</sup>	40~210	40~210	40~210	40~210		40~280	40~380
Oil Flow	LPM	10~20	10~20	10~20	10~20		10~20	10~20
Pin Diameter	mm	ø30	ø35	ø40	ø45		ø55	ø65
Range of Center	mm	140~170	170~210	180~225	255~355		275~360	355~485
Excavator Class	ton	1.6~1.7	2.7	3.5	5		8	14

Description	Unit	DMQ170TS	DMQ230TS	DMQ290TSS	DMQ360TSS	DMQ500TSS
Manufacturing Type		Welding				
Operating Mode		Sliding + Triple Safety		Swing(Push) + Triple Safety		
Operating Weight	kg	254	300	496	648	671
Setting Pressure	Kgf/cm <sup>2</sup>	40~380	40~380	40~380	40~380	40~380
Oil Flow	LPM	10~20	10~20	10~20	10~20	10~20
Pin Diameter	mm	ø70	ø80	ø90	ø100	ø120
Range of Center	mm	370~503	380~504	510~575	545~630	560~620
Excavator Class	ton	17	21	30	36	45~50

# Material Handler

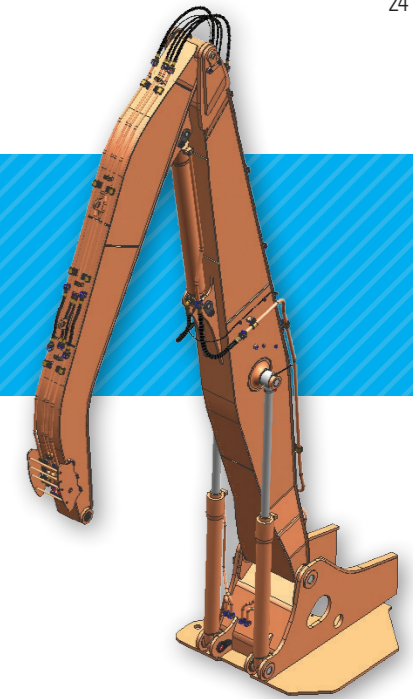

### FEATURES

- Low-alloy steel increased maximum strength to weight.
- Standard package : Boom + Arm
- Various kinds of grapple and clamshell bucket can be installed

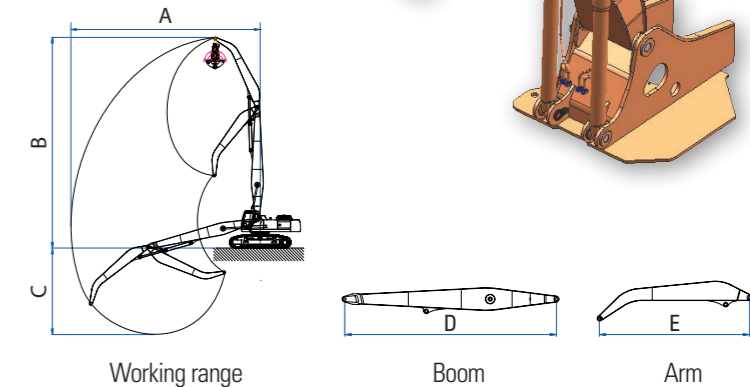

### SPECIFICATIONS

Description	Unit	Wheel		Crawler						
		DMMH2140	DMMH2200	DMMH2140	DMMH2210	DMMH2290	DMMH2320	DMMH2360	DMMH2480	DMMH2520
(A) Max Operating Reach	mm	9,060	11,000	9,060	11,100	13,000	13,680	14,950	16,800	16,700
(B) Max Operating Height	mm	10,630	12,670	9,800	12,500	14,500	15,030	16,350	18,300	17,650
(C) Max Operating Depth	mm	4,150	4,700	4,400	4,800	6,200	6,420	7,400	6,900	7,740
(D) Boom Length	mm	5,550	6,500	5,550	6,500	7,800	7,800	8,600	10,000	10,000
(E) Arm Length	mm	3,850	4,500	3,850	4,500	5,400	6,050	6,050	7,100	7,100
Lift capacity at Maximum Reach	kg	(SNS : 1.6 Ton)	(SNS : 2.4 Ton)	(SNS : 1.6 Ton)	(SNS : 2.4 Ton)	(SNS : 2.6 Ton)	(SNS : 2.6 Ton)	(SNS : 3.0 Ton)	(SNS : 3.5 Ton)	(SNS : 3.5 Ton)
Additional Counter Weight	kg	(SNS : 1.0 Ton)	(SNS : 1.5 Ton)	(SNS : 1.0 Ton)	(SNS : 1.5 Ton)	(SNS : 2.0 Ton)	(SNS : 2.0 Ton)	(SNS : 2.5 Ton)	(SNS : 3.0 Ton)	(SNS : 3.0 Ton)
Suitable Excavator	ton	14~20	20~27	14~20	21~25	27~32	32~40	32~40	40~50	50~60

# Clamshell Bucket

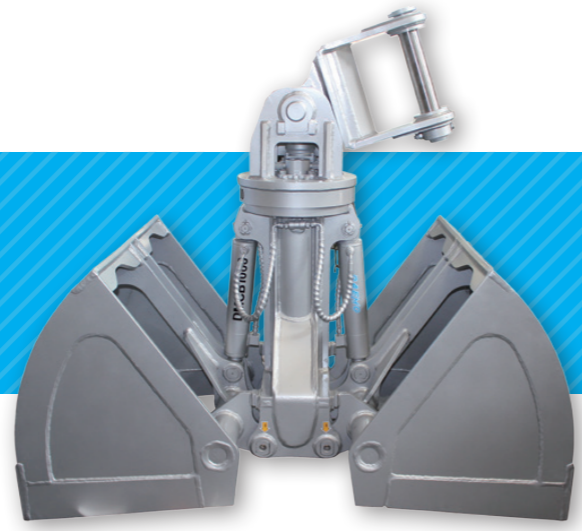

## FEATURES

- Pendulum Type.
- Rotating Options :
  - Hydraulic Rotating Type, Free Rotating Type, Fixed Type Available.
- Tooth can be installed as Option.
- Standard Clamshell has no tooth.

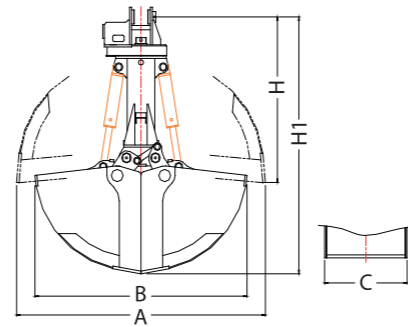

## SPECIFICATIONS

Description	Unit	DMCB800	DMCB1000	DMCB1200
Operating Weight	kg	980	1,420	1,600
Capacity	m <sup>3</sup>	0.8	1	1.2
(A) Max Opening Width	mm	2,027	2,027	2,027
(B) Max Closing Width	mm	1,837	1,837	1,837
(C) Jaw Width	mm	800	1,100	1,400
(H) Height (Open)	mm	1,442	1,442	1,442
(H1) Overall Length	mm	2,147	2,147	2,147
Self Digging force (Minimum, Open point)	kgf	5,705	5,705	
Excavator Class	ton	18-25	25-32	32-38



Quality is our only product



BMS Board & Ultra Sonic Machine

Test Bench

Test Facility